

**RHINO-RACK®**2500 **SPORTZ** SUPPLEMENT SHEET

| VEHICLE | KIT | CROSSBAR |
|-----------------------------------|--------|----------|
| Toyota Hilux Double Cab Gen 8 4dr | DK430F | SZ126 |
| RUNNING DATES | 10/15- | |
| VEHICLE NOTES | | |

VISIT THE ONLINE
CALCULATOR FOR CURRENT
SYSTEM LOAD LIMIT DATA

**DYNAMIC ROAD LOAD LIMIT** (NOTE: DIFFERENT ON AND OFF ROAD CARGO LIMIT)***USE THE VEHICLE MANUFACTURER'S MAXIMUM ROOF ALLOWANCE IF IT IS LOWER THAN THE FIGURE LISTED**

LOAD LIMIT

UP TO **35 kg ***
77 lb



SYSTEM WEIGHT

— **32.5 kg** =
6 lb



ON ROAD CARGO LIMIT

UP TO **33 kg**
72 lb

OR

OFF ROAD CARGO LIMIT
(ON ROAD CARGO LIMIT / 2)

UP TO **22 kg**
48 lb

PAD AND CLAMP DETAILS

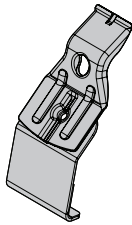

CLAMP ID:
SUB0641

PLATE ID:
M311

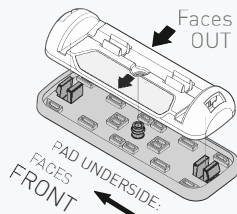

PAD ID:
M697

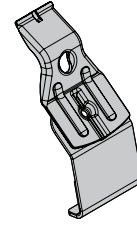
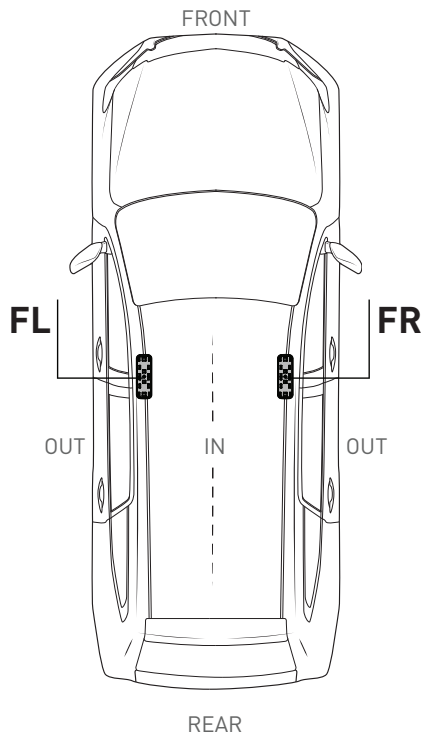

CLAMP ID:
SUB0641

PLATE ID:
M311

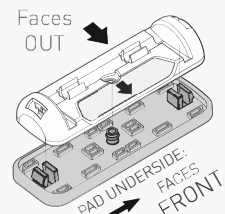

PAD ID:
M698

MEASUREMENT STRIPS

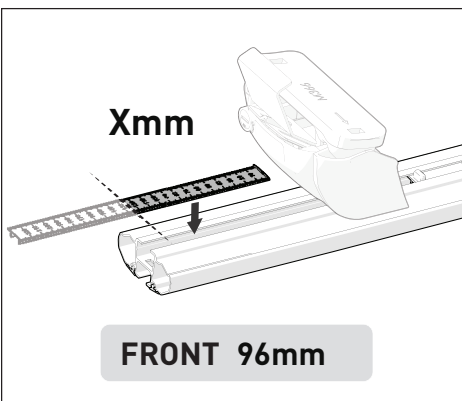

VEHICLE POSITIONING

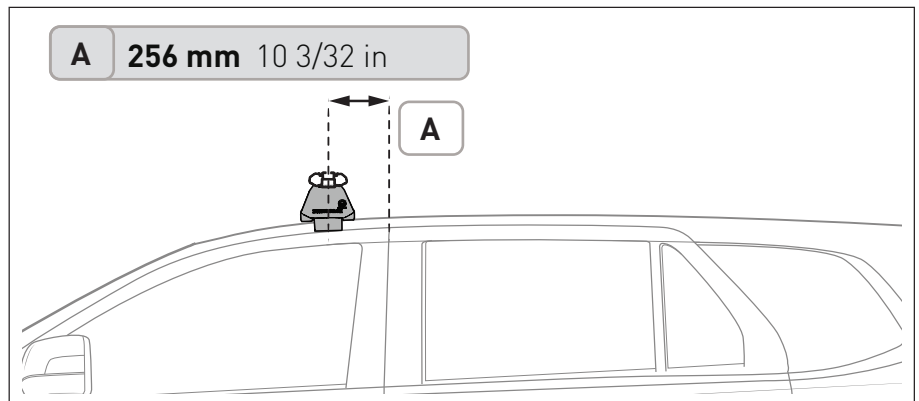

NOTES FOR DEALERS / FITTERS

It is your responsibility to ensure these fitting instructions are given to the end user or client.

Document No: R4676
Issue No: 1
Issue Date: 14-Jan-25